

**NOTE: JOINING OF EDGE METAL PIECES**

1. INSTALL METAL CORRECTLY
2. APPLY 1" WIDE ALUMINUM TAPE OVER JOINT GAP
3. WELD IN MEMBRANE EDGE FLASHING STRIP ONTO METAL AND THE ROOF MEMBRANE.
4. WELD IN 4-6" WIDE FLASHING STRIP OVER TAPE COVERED JOINT GAP ON THE EDGE FLASHING STRIP

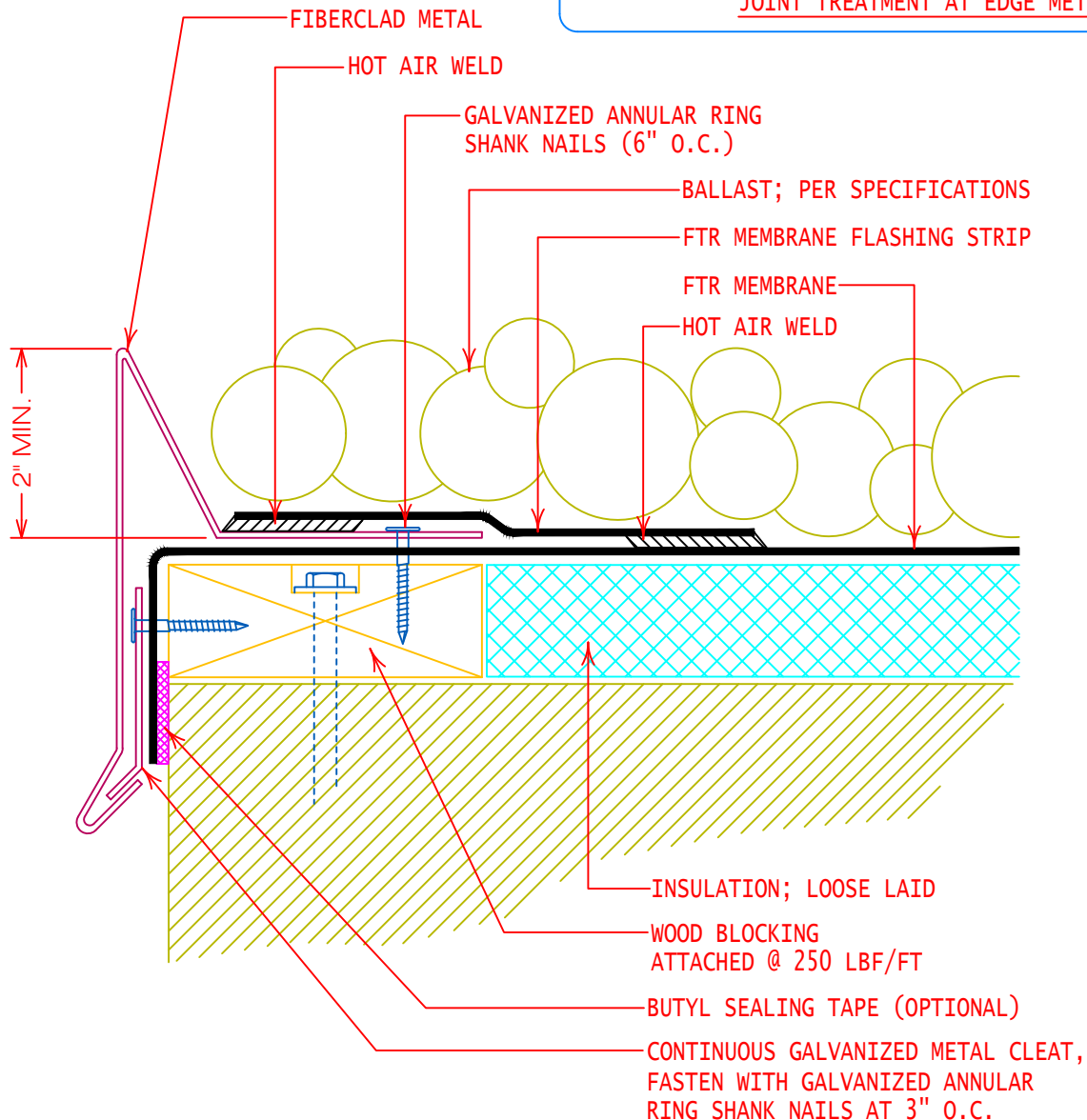
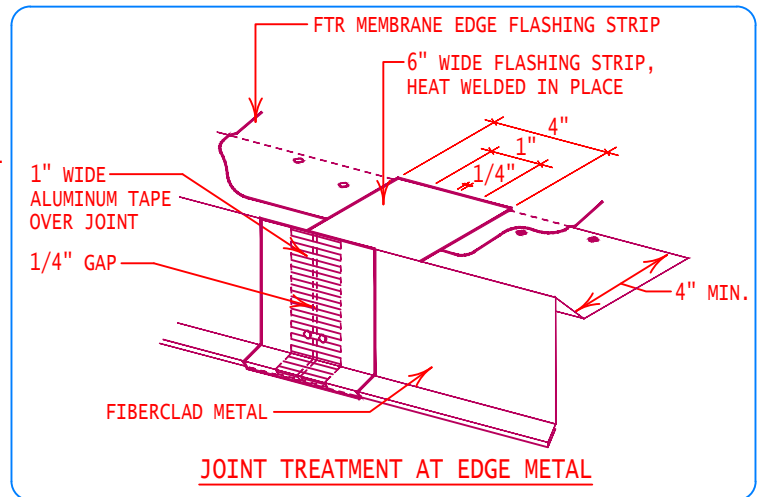

GENERAL REFERENCE:  
"FTR GS 01/21"  
APPLICABLE SYSTEMS:  
"FTR BA 01/21"

**FIBERCLAD METAL "GRAVEL STOP" FLASHING  
BALLAST ROOFING SYSTEM(S)**

REVISES DETAIL

ALL PREVIOUS

ISSUE DATE

02-10-14

DRAWING NUMBER

FTR-DE6