

FIBERTITE 200 FASCIA SYSTEM				
PRODUCT ID. NO.	H DIMENSION	X DIMENSION	NAILER COVERAGE	
FAF-50	5" (127.0 mm)	3" (76.2 mm)	1 NAILER	
FAF-65	6-1/2" (165.1 mm)	4-1/2" (114.3 mm)	2 NAILERS	
FAF-80	8" (203.2 mm)	6" (152.4 mm)	3 NAILERS	
FAF-95	9-1/2" (241.3 mm)	7-1/2" (190.5 mm)	4 NAILERS	
FAF-110	11" (279.4 mm)	9" (228.6 mm)	5 NAILERS	
FAF-125	12-1/2" (314.5 mm)	10-1/2" (266.7 mm)	6 NAILERS	
FM APPROVED UP TO 1-195				

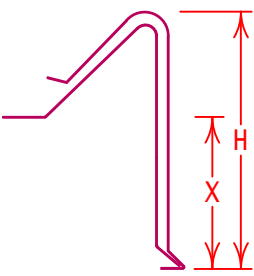

NOTE:
INSTALL PRE-MANUFACTURED EDGE
SYSTEM PER SPECIFICATIONS AND
FIBERTITE'S INSTALLATION
REQUIREMENTS.

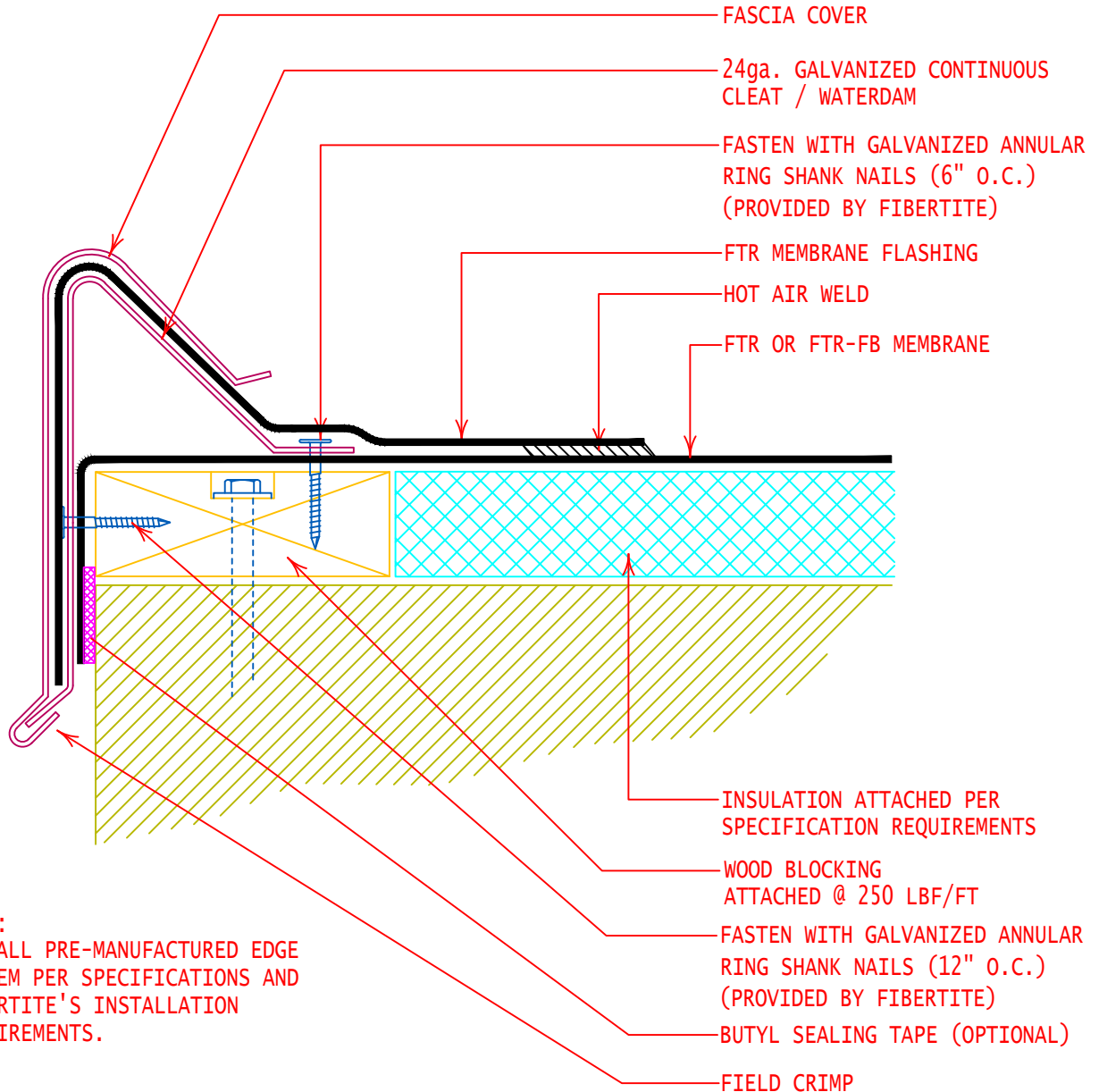

GENERAL REFERENCE:
"FTR GS 01/21"
APPLICABLE SYSTEMS:
"FTR MA 01/21"
"FTR AD 01/21"
"FTR BA 01/21"

FIBERTITE 200 FASCIA SYSTEM (RAISED CLEAT EDGE)

REVISES DETAIL
ALL PREVIOUS

ISSUE DATE
02-10-14

DRAWING NUMBER
FTR-DE8a