

NOTE:
 BOTTOM LAYER OF INSULATION SHALL BE LAID DOWN IN
 A STAGGERED PROFILE. STAGGER AND OFFSET TOP LAYER
 OF INSULATION FROM BOTTOM LAYER TO PREVENT
 ALIGNED EDGES.

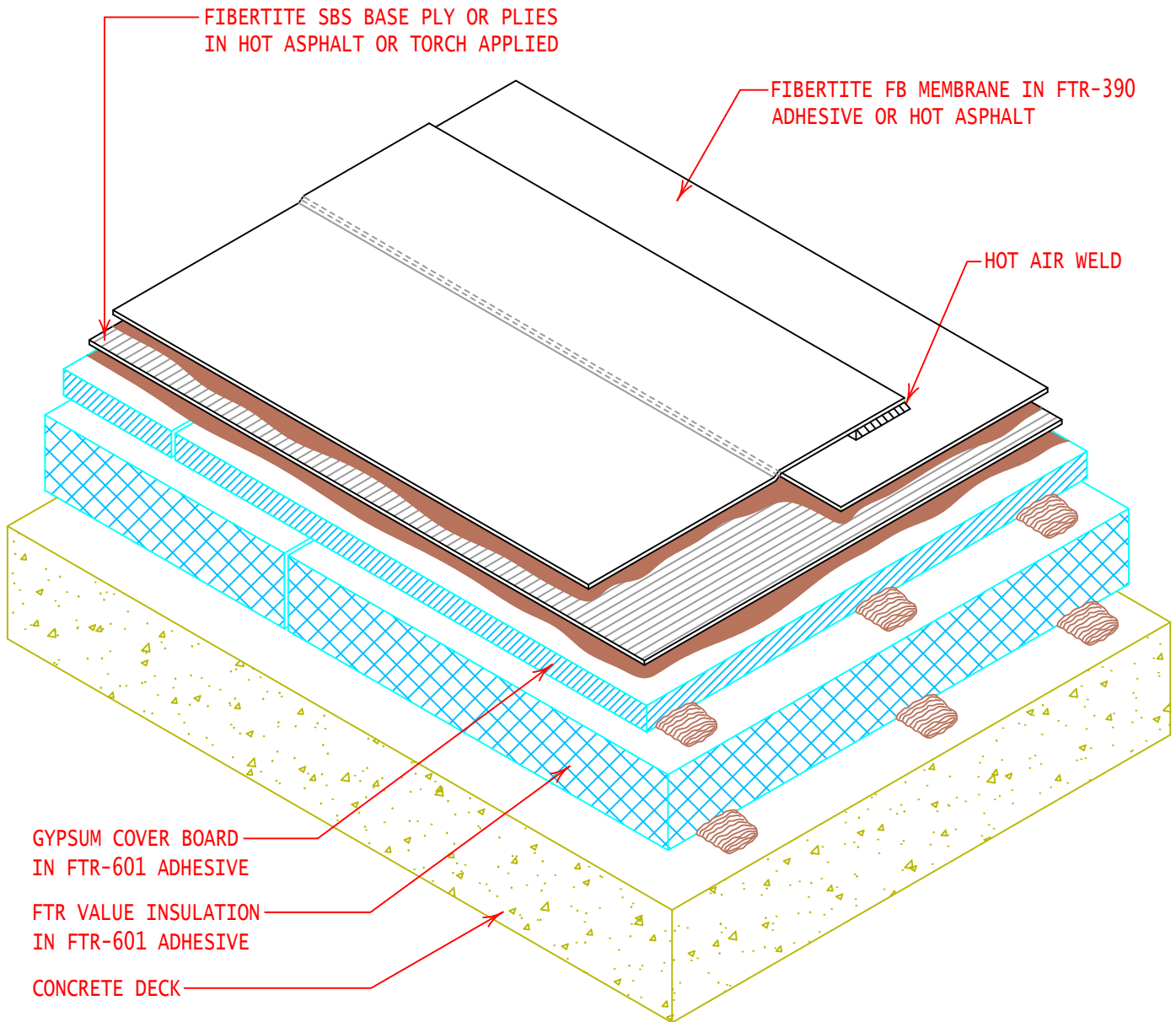

GENERAL REFERENCE:
 "FTR GS 01/21"

APPLICABLE SYSTEMS:
 "FTR MP 01/21"

MULTI-PLY ROOF SYSTEM CROSS SECTION (ADHERED INSULATION IN FTR-601 ADHESIVE)

REVISES DETAIL

ALL PREVIOUS

ISSUE DATE

08-13-13

DRAWING NUMBER

FTR-DAS3MP