

NOTE:
INSULATION SHALL BE LAID DOWN IN
A STAGGERED PROFILE.

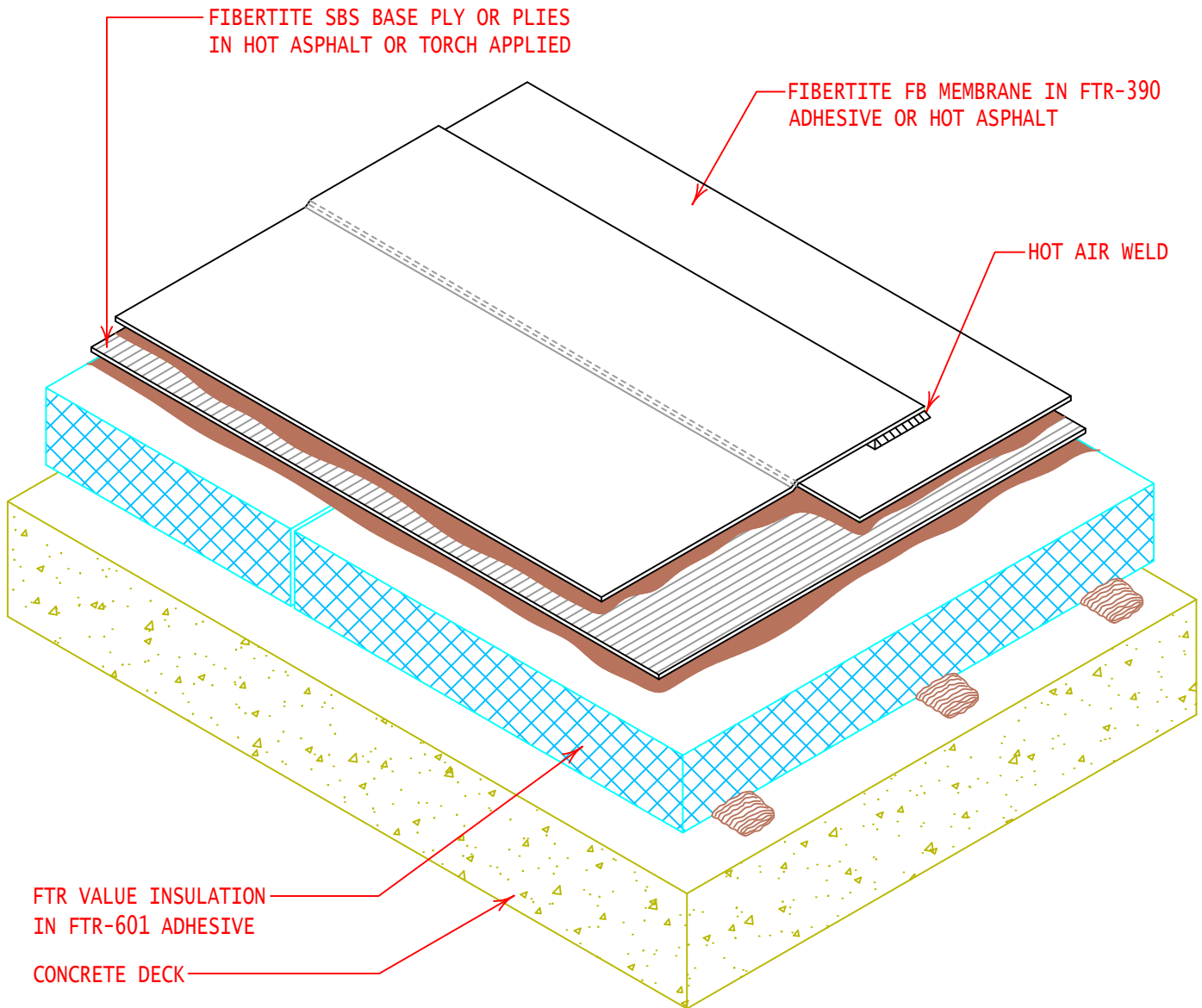

GENERAL REFERENCE:
"FTR GS 01/21"

APPLICABLE SYSTEMS:
"FTR MP 01/21"

MULTI-PLY ROOF SYSTEM CROSS SECTION
(ADHERED INSULATION IN FTR-601 ADHESIVE)

REVISES DETAIL

ALL PREVIOUS

ISSUE DATE

08-13-13

DRAWING NUMBER

FTR-DAS7MP